

Datasheet - Emergency Pull-Wire Switch Extreme - ZS 92 S

ZS 92 S 22 VD F -40°C ... +85°C IP66/67 Extreme Material no.: 1457232

Product features

- Temperature resistant from -40 °C to +85 °C
- High degree of protection IP66 / IP67
- Corrosion-resistant aluminium enclosure
- Screws made of stainless steel
- Wire length up to 2 x 100 m
- Release by lever
- F = Reset lever at the front side
- Back and base mounting possible
- Wire pull and breakage detection

Notes

- At 3 m distance intermediate wire supports are required. Two compensation springs type ZS 90/91/92 S must be installed, see accessories.

Dimensions

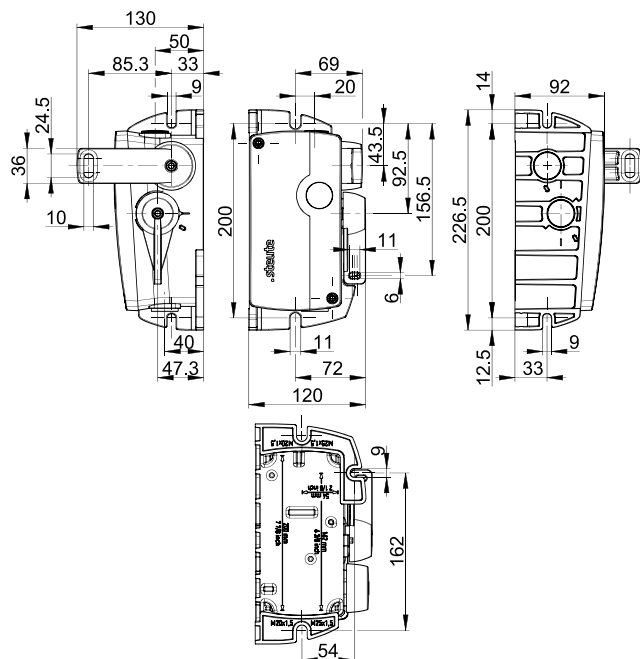

Technical data

Applied standards

EN 60947-5-1, EN 60947-5-5, EN ISO 13850, EN ISO 13849-1, EN 620:2011-5.7.2.9, AS 1755-2000-2.7.9.1, AS/NZS 4024.3610:2015-2.10.6.2

Enclosure

aluminium die-cast, corrosion-resistant, powder-coated, passivated, shockproof, anthracite grey, similar to RAL 7016

Cover

aluminium die-cast, corrosion-resistant, powder-coated, passivated, shockproof, signal yellow, similar to RAL 1003

Actuating lever

aluminium die-cast, corrosion-resistant, powder-coated, passivated, shockproof, signal red, similar to RAL 3001

Reset lever

aluminium die-cast, corrosion-resistant, powder-coated, passivated, shockproof, sky blue, similar to RAL 5015

Screws

stainless steel

Tightening torque

cover screws: max. 2.5 Nm
actuator screws: max. 6 Nm

Degree of protection

IP66/IP67 (IEC/EN 60529)

B10d (10 % load)

100 000

T_M

max. 20 years

Contact material

silver

Switching system

snap action, positive break NC contacts ⊕

Switching elements

2 NC/2 NO contacts, type Zb

Connection

screw connection terminals

Cable cross-section

0.5 ... 2.5 mm² (incl. conductor ferrules)

Cable entry

2 x M25 x 1.5

Rated impulse withstand voltage U_{imp}

6 kV

Rated insulation voltage U_i

400 V

Conventional thermal current I_{the}

6 A

Datasheet - Emergency Pull-Wire Switch Extreme - ZS 92 S

ZS 92 S 22 VD F -40°C ... +85°C IP66/67 Extreme Material no.: 1457232

Technical data (contd.)

Conditional short-circuit current
1100 A

Rated operating current/voltage I_e/U_e
6 A/400 VAC

Utilisation category
AC-15

Short-circuit protection
6 A gG/gN fuse

Mechanical life
> 50 000
operations

Max. wire length
2 x 100 m

Ambient temperature
-40 °C ... +85 °C

Degree of pollution
3

Actuating force
actuating lever approx. 30 N; reset lever approx. 40 N

Approvals



Weight
2260 g

Switching diagram

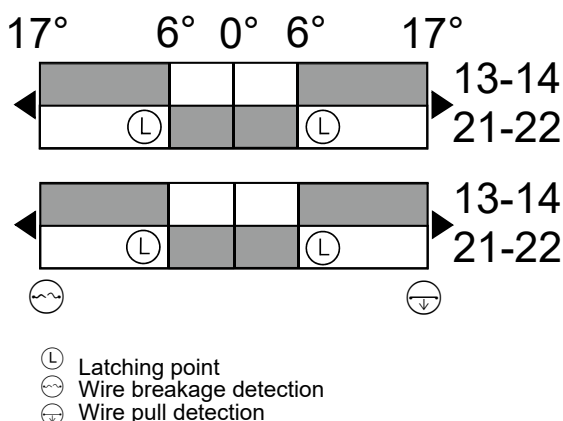

Contact diagram

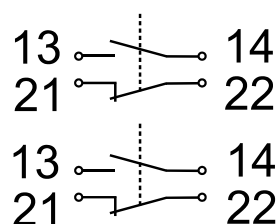

This product has been designed by Steute GMBH in accordance with Australian Standards.

However, the customer is required to assess how this product complies in their specific application to meet the Australian Standard or their company's safety protocols.