

K-Conveyor Pulleys Worksheet

Kinder Reference Drawing: 1072

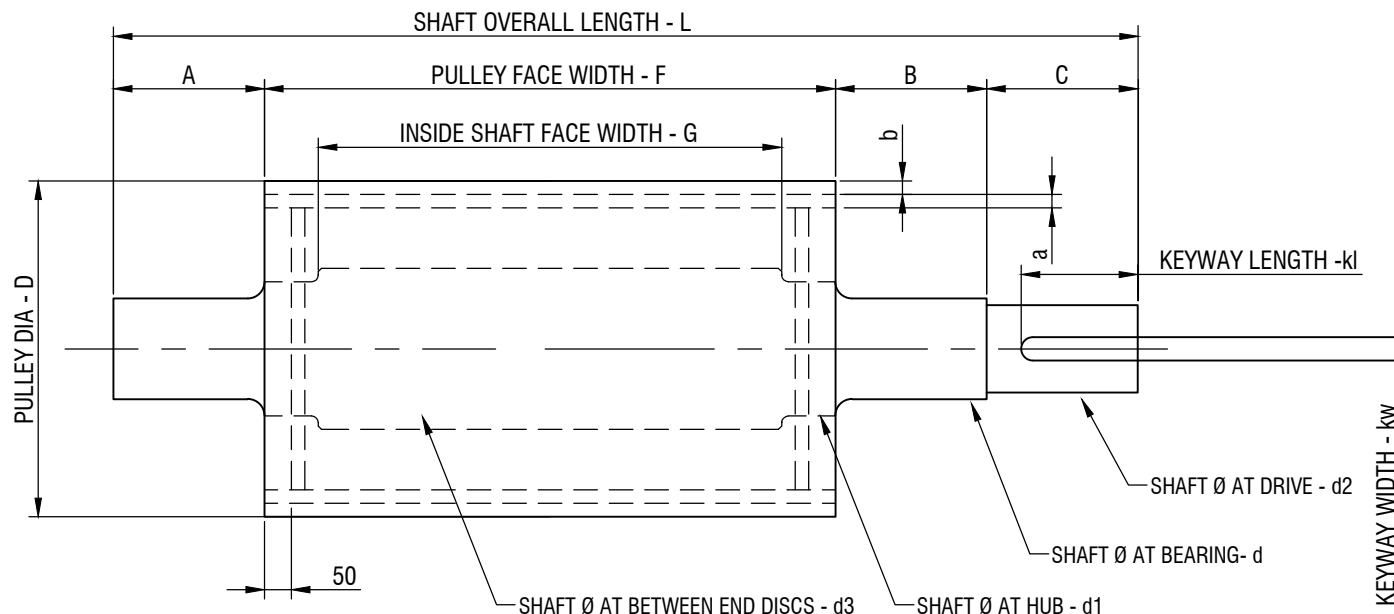

NOMINATE ANY SPECIAL SHAFT OR PULLEY REQUIREMENTS UPON ORDERING

ALL DIMENSIONS - mm

PULLEY :	SHAFT:	KEYWAY:	SHAFT ATTACHMENT:	LAGGING	YES	NO
OVERALL DIAMETER -D	DIA AT BEARING-d	KEYWAY WIDTH kw	WELDED TO PULLEY	PULLEY WITH LAGGING:		
PULLEY FACE WIDTH -F	DIA AT HUB-d1	KEYWAY LENGTH kl	LOCKING ELEMENT TO PULLEY	LAGGING THICKNESS-b		
SHAFT FACE WIDTH -G	DIA AT DRIVE-d2	NEED TO BE SUPPLIED WITH KEY	TAPERLOCKED TO PULLEY	DIAMOND GROOVED		
SHELL THICKNESS -a	DIA AT BETWEEN DISCS-d3		OTHER	PLAIN FINISH		
CROWNED: YES NO	SHAFT LENGTHS: OVERALL LENGTH -L			CERAMIC		
SPEED - rev/min	A. B C					
	BEARINGS with cylindrical bore					
	CODE:- with adapter sleeve					

Issue Date: 31/01/2018

K-WS-K-Conveyor Drive Pulley; Rev. 1;



Kinder Australia Pty Ltd

P | +61 3 8587 9111 F | +61 3 8587 9101 E | sales@kinder.com.au
26 Canterbury Rd, Braeside VIC 3195 (PO Box 1026, Braeside VIC 3195)

Subject to © Kinder Australia Pty Ltd

Page 1



www.kinder.com.au

abn 28 006 489 238



K-Conveyor Pulleys Worksheet

Name: _____

Company: _____

Site/Operation Location: _____

Contact Number: _____

Email: _____

Date: _____

Entered or Approved
by Kinder Employee: _____

Kinder Document ID: _____

K-WS-K-Conveyor Drive Pulley; Rev. 1;

Issue Date: 31/01/2018



abn 28 006 489 238

www.kinder.com.au



EXPERIENCE INNOVATION PRODUCTIVITY

Kinder Australia Pty Ltd

P | +61 3 8587 9111 F | +61 3 8587 9101 E | sales@kinder.com.au

26 Canterbury Rd, Braeside VIC 3195 (PO Box 1026, Braeside VIC 3195)

Subject to © Kinder Australia Pty Ltd

Page 2

