

Product: K-Bar Secondary Cleaner

Product category: Belt Cleaning System Products

Overview:

The function of the K-Bar Secondary Cleaner is to clean the conveyor belt. It is designed to be installed behind the head pulley. These units are suited to conveyor belt widths from 450mm up to 1500mm. To achieve the best result it should be used in conjunction with a primary belt cleaner.

(NOTE: this unit is unsuitable for reversing belts)

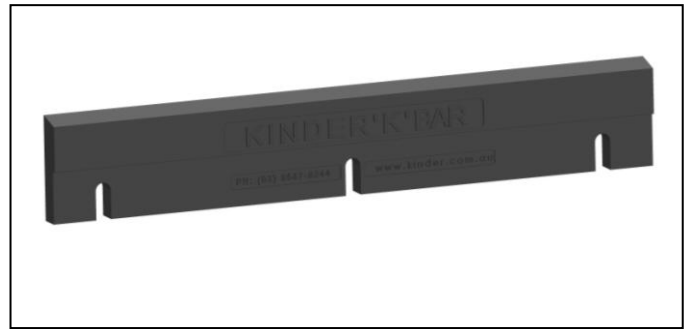
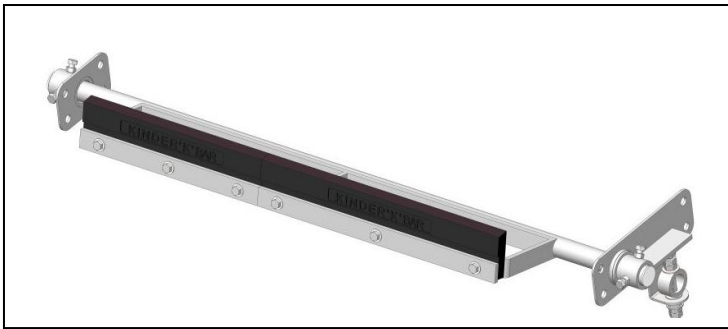

Procedure:

1. Isolate, lock and danger tag the conveyor at the main positive isolator.
2. Check that all items are complete. As per drawing and parts list supplied.
3. Select suitable location and install as per the drawing Figure A. The dimensions are critical to cleaning efficiency and blade life.
4. All arrangements can be supplied with additional mounting plate that permits the removal of the frame from either side of an enclosed chute. See Figure B.
5. Adjust cleaner using the tensioner. Twin tensioners are supplied with 750 mm model and larger. Adjustment should be "light". Over tensioning will wear the elements out prematurely. Refer Figure C.
6. Remove all tools and equipment.
7. Replace guards.
8. Remove personnel danger tags. Unlock main positive isolator and close. Start belt on test or manual control.
9. Return conveyor to service and observe performance.

Installation Instructions - K-Bar Secondary Cleaner

FIGURE B

ITEM NO.	DESCRIPTION	PART NO.	REMARKS
1	TENSIONING SUPPORT MOUNT	K8006 - 10	
2	TENSIONING SUPPORT	K5000 - 20	A = RH B = LH
3	SUPPORT BUSH	K5000 - 80	
4	TENSION END STOP	K5000 - 60	
5	TENSION BOLT	K5000 - 21A	
6	STOP BOLTS		
7	SUPPORT	K5000 - 30	
8	END STOP	K5000 - 50	
9	POLY TENSION SPRING	K5000 - 70	

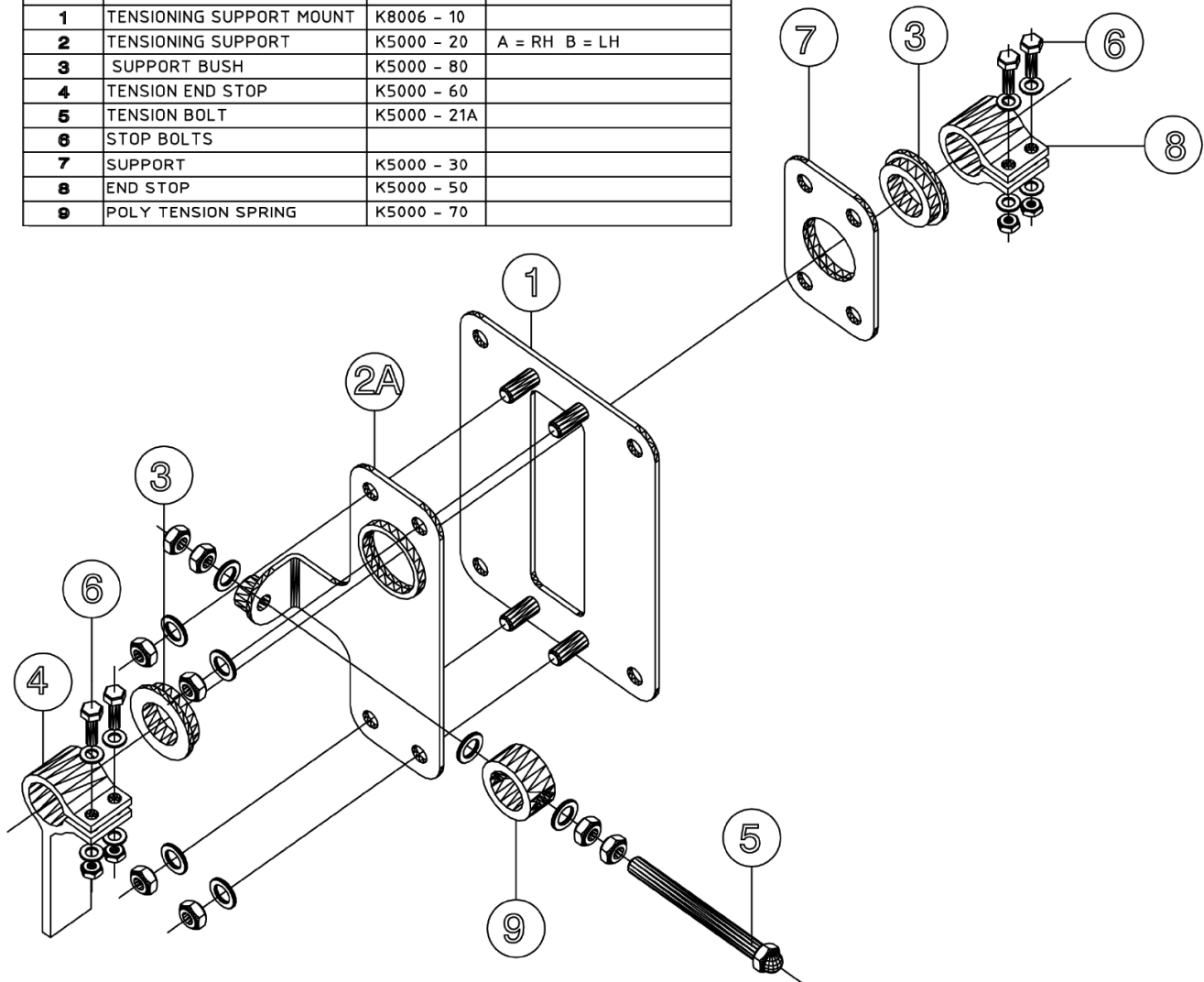

Installation Instructions - K-Bar Secondary Cleaner

FIGURE C

